

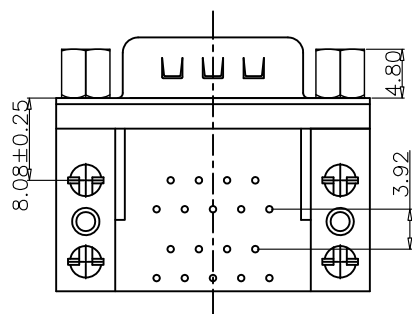

REVISIONS				
LTR	DESCRIPTION	DATE	DWN	APVD
A	RELEASED	01Jan16	AW	WK

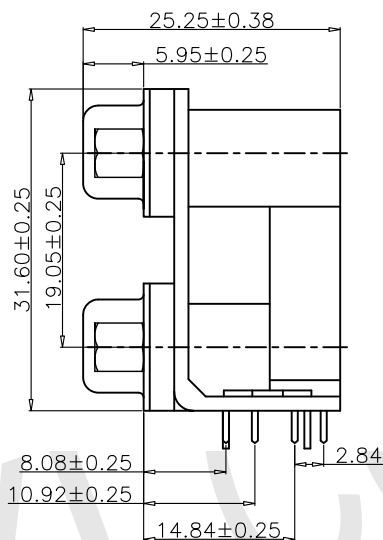
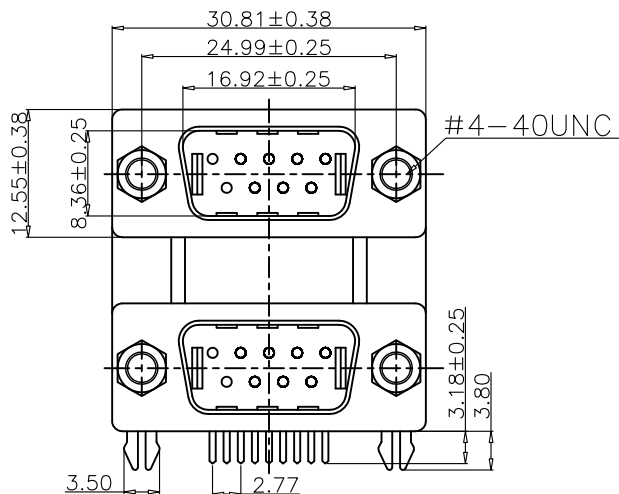

NOTE:

- MATERIALS AND FINISHED
 INSULATOR : LCP OR PBT+30% GF UL 94V-0,
 SHELL : STEEL, Ni FINISHED
 CONTACT MATERIAL:BRASS, SELEVITE GOLD FINISHED
 HARPOON:BRASS,Sn FINISHED
 RIVET:COPPER ALLOY ,Ni FINISHED
 WITH #4-40 THREADED ASSEMBLED
- ELECTRICAL CHARACTERISTICS
 CURRENT RATING : 1.0 AMP DC
 VOLTAGE RATING: 300 V DC
 CONTACT RESISTANCE :20 MILLIOHMS MAX.
 DIELECTRIC WITHSTANDING VOLTAGE : 1000 V AC MIN.
 INSULATION RESISTANCE : 5000 MEGAOHMS MIN.
- ENVIRONMENTAL
 OPERATING TEMPERATURE: -55°C ~ +85°C
 STORAGE TEMPERATURE:-55°C ~ +105°C

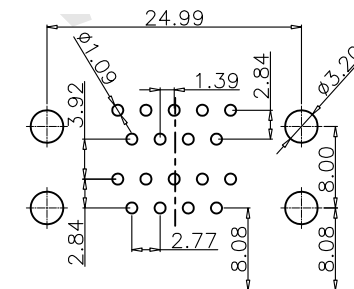

RECOMMENDED PCB LAYOUT THICKNESS=1.6mm
 TOLERANCE:±0.05

YL013-010-001
 PART NUMBER

THIS DRAWING IS A CONTROLLED DOCUMENT.		DWN A. WU 01Jan2016	东莞市宇亮电子有限公司 DONG GUAN YU LIANG ELECTRONICS CO.,LTD	
DIMENSIONS: mm		CHEK S. CHIEN 01Jan2016		
 THIRD ANGLE PROJECTION		APVD Abel 01Jan2016	D-SUB Right Angle Connector Dual Row	
TOLERANCES UNLESS OTHERWISE SPECIFIED: 0 PLC ± 0.50 1 PLC ± 0.30 2 PLC ± 0.20 3 PLC ± 0.15 4 PLC ± - ANGLES ± 3°		PRODUCT SPEC -	SIZE A4	DRAWING No. C=YL013-010
		WEIGHT -	CUSTOMER DRAWING	SCALE 1 : 1 SHEET 1 of 1